



Electrolux

Digital Cabinets 400lt Line Wine Refrigerator, 1 Glass Door (Black)

ITEM # _____

MODEL # _____

NAME # _____

SIS # _____

AIA # _____



Electrolux



Digital Cabinets

400lt Line Wine Refrigerator, 1 Glass Door (Black)

730900 (R04P6SRB)

1-glass door wine refrigerator 400lt, +4/+19°C, black finishing and smoked grey glass, rilsan grids

Short Form Specification

Item No.

Exterior in black painted steel. Interior in grey High Impact Polystyrene with rounded corners and 45mm thick insulation. Right hinged "smoked grey" glass door with lock, reversible on-site. Built-in refrigeration unit; black control panel; electro-mechanical control; internal light. Cell temperatures: upper part +16/+19°C; +13/+15°C; middle part +10/+12°C; +7/+9°C; lower part +4/+7°C. For ambient temperatures up to 32°C. HCFC, CFC and HFC free insulation and R134a refrigerant gas.

Supplied with n. 3 grids 600x400mm and n. 1 grid 600x285mm PE coated. Max. capacity: 211 bottles (750ml) in horizontal position and 114 bottles in upright position.

Main Features

- Shelf runners are thermoformed and are incorporated in the internal structure to be easily cleanable.
- Model requires only 1 phase 220/240V supply and can be plugged straight into an existing power socket.
- Whole interior cell with rounded corners is white thermoformed polystyrene, which is impact resistant.
- No joints whatsoever to eliminate dirt traps.
- Simple refrigeration system easily accessible from the rear of the units.
- Very quiet operation: noise level less than 55 dB (A).
- Attractive presentation through glass door and lighting.
- Different temperatures for different zones in the cavity to store different types of wines.
- Suitable for use in ambient temperatures of up to 32 °C.
- Model equipped with roll-bond plate that has a plate installed in the internal backside of the unit equipped with a special thermostat to avoid ice formation.

Construction

- Developed and produced in ISO 9001 and ISO 14001 certified factory.
- All models in range are finished in top quality materials to aid durability.
- CFC and HCFC free (ecological refrigerant type: R134a, - gas in foam: cyclopentane).

Included Accessories

- 1 of 3 rilsan grids for 400lt wine refrigerator PNC 880131

Optional Accessories

- 3 rilsan grids for 400lt wine refrigerator PNC 880131
- Inclined rilsan shelf for 400lt wine refrigerator PNC 880138
- Kit for 3 wooden shelves for 400lt wine refrigerator PNC 880187

APPROVAL: _____



Electrolux

Digital Cabinets 400lt Line Wine Refrigerator, 1 Glass Door (Black)

Front

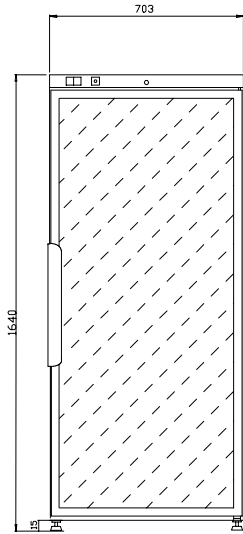

Top

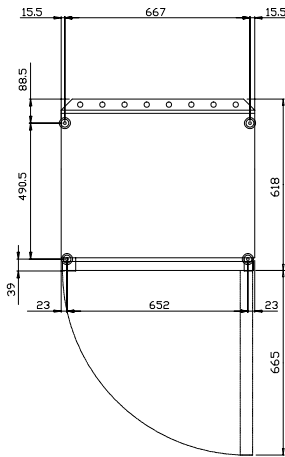

Side

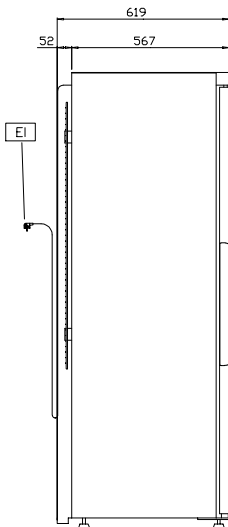

EI = Electrical connection

Electric

Supply voltage:

730900(R04P6SRB)

230 V/1N ph/50 Hz

Connected load:

0.21 kW

Key Information:

Door hinges:

Right Side

External dimensions, Height:

1640 mm

External dimensions, Width:

703 mm

External dimensions, Depth with
Doors Open:

1310 mm

Internal Dimensions (depth):

435 mm

Internal Dimensions (height):

1450 mm

Internal Dimensions (width):

610 mm

Gross capacity:

400 lt

Number and type of grids
(included):

3 - 600x400

Type of external material:

Prepainted Steel

Refrigeration Data

Control type:

Mechanical

Compressor power:

1/5 hp

Refrigerant type:

R134a

Refrigeration power:

156 W

Refrigerant weight:

240 g

Min/Max internal humidity:

70/70

Operating temperature min.:

4 °C

Operating temperature max.:

19 °C

Operating mode:

Static

Cooling unit:

Built-In

Defrost type:

not needed



Digital Cabinets
400lt Line Wine Refrigerator, 1 Glass Door (Black)

The company reserves the right to make modifications to the products without prior notice. All information correct at time of printing.

2012.09.28